

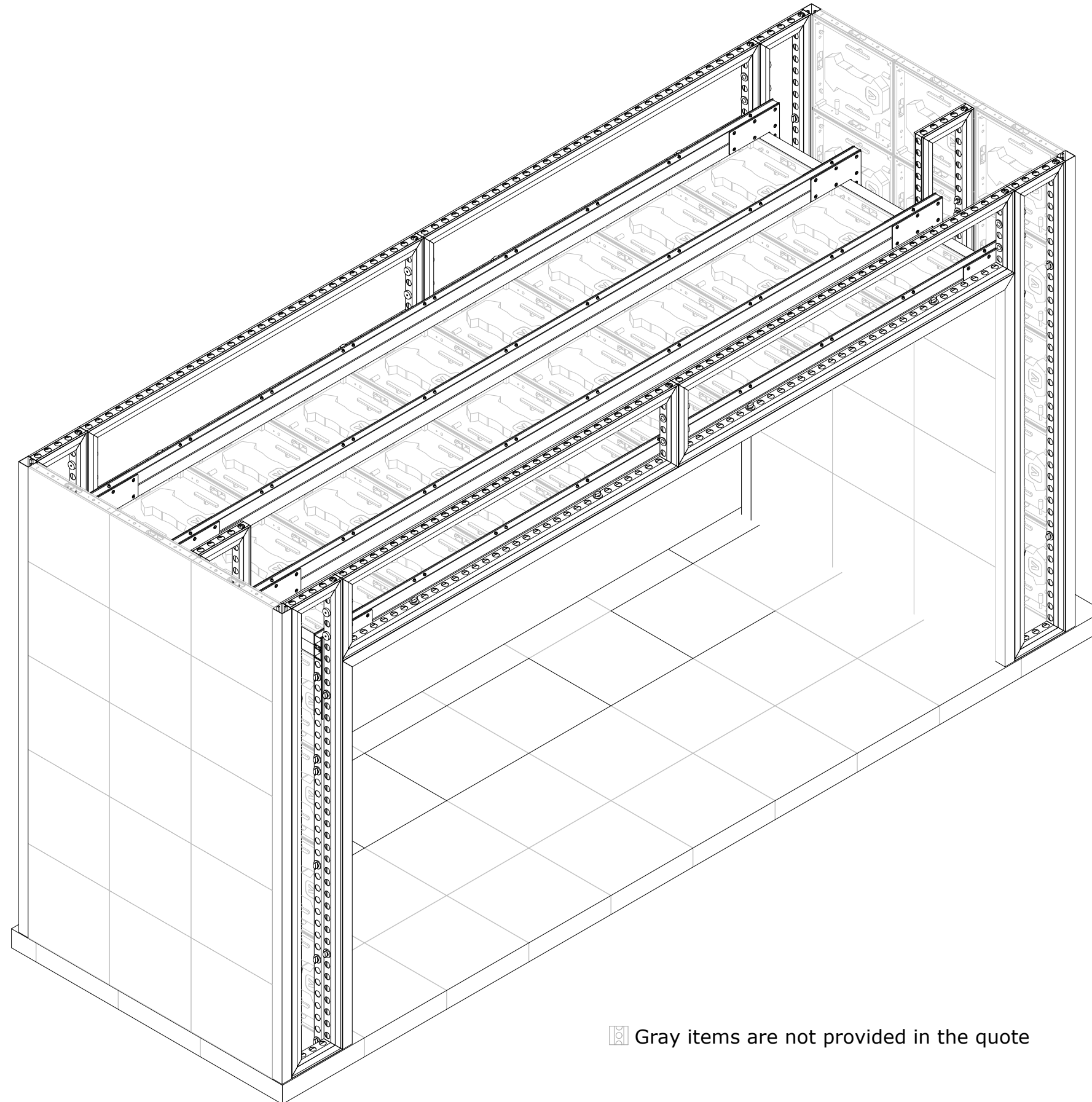

# Overview



 Gray items are not provided in the quote

Client	The Event Co. - London Ltd	Project	SQ1-25014689	Page 1 / 4
Ref.	LED bridge structure	Author	WDT	
Date	26/05/2025	Version	2	
+32 (0)56 17 19 60 - www.aluvision.com				



# Structure

Finishing structure and reinforcement frames - Parts

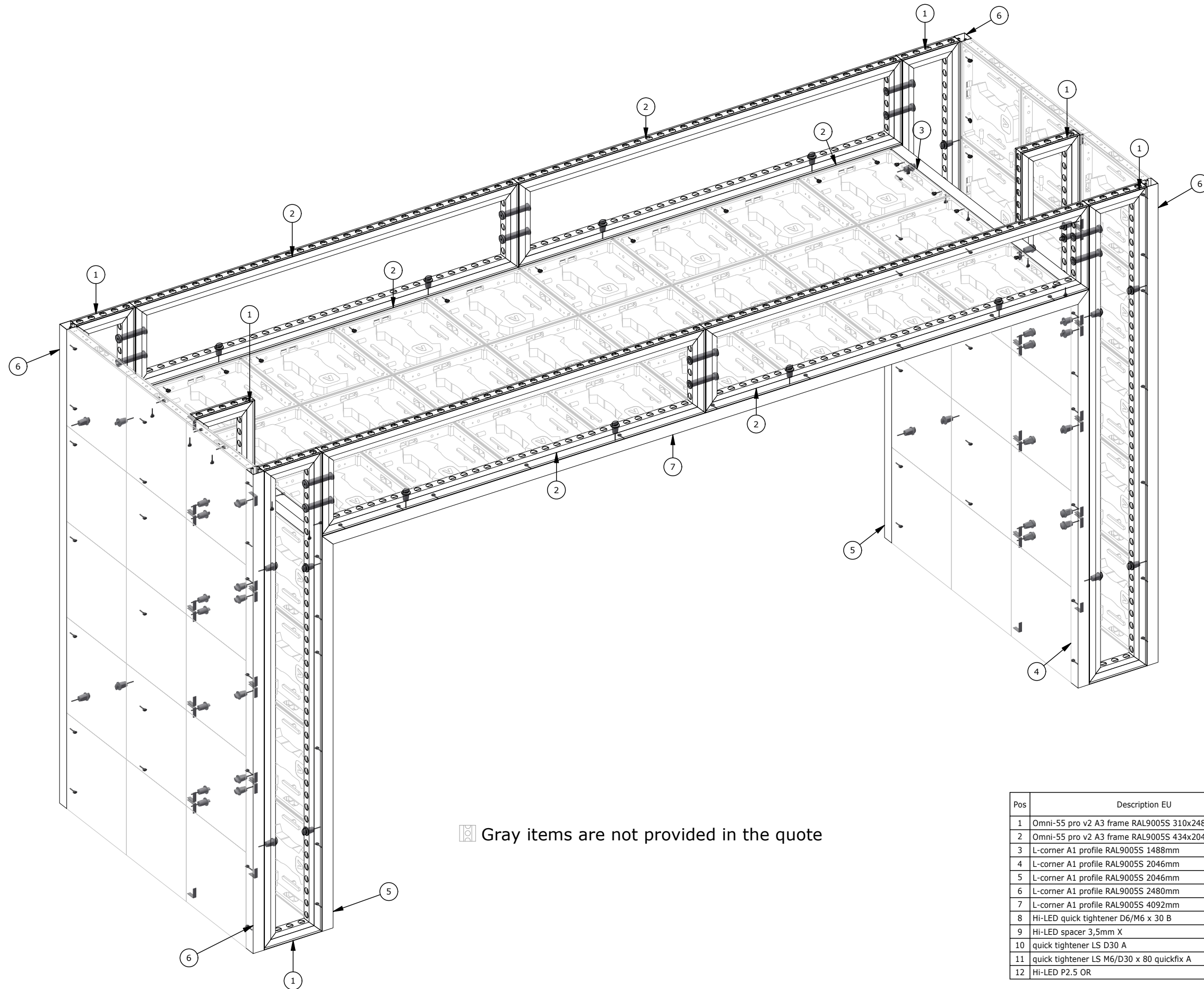

 Gray items are not provided in the quote

Pos	Description EU	Qty	Comments EU
1	Omni-55 pro v2 A3 frame RAL9005S 310x2480	6	
2	Omni-55 pro v2 A3 frame RAL9005S 434x2046	4	
3	L-corner A1 profile RAL9005S 1488mm	2	(90-90)
4	L-corner A1 profile RAL9005S 2046mm	2	(90-45V)
5	L-corner A1 profile RAL9005S 2046mm	2	(45V-90)
6	L-corner A1 profile RAL9005S 2480mm	4	(90-90)
7	L-corner A1 profile RAL9005S 4092mm	2	(45V-45V)
8	Hi-LED quick tightener D6/M6 x 30 B	92	Not in quote!
9	Hi-LED spacer 3,5mm X	36	Not in quote!
10	quick tightener LS D30 A	12	Not in quote!
11	quick tightener LS M6/D30 x 80 quickfix A	50	Not in quote!
12	Hi-LED P2.5 OR	78	Not in quote!

Client	The Event Co. - London Ltd	Project	SQ1-25014689	Page 2 / 4
Ref.	LED bridge structure	Author	WDT	
Date	26/05/2025	Version	2	
+32 (0)56 17 19 60 - www.aluvision.com				

# Structure

Extend reinforcement - Parts

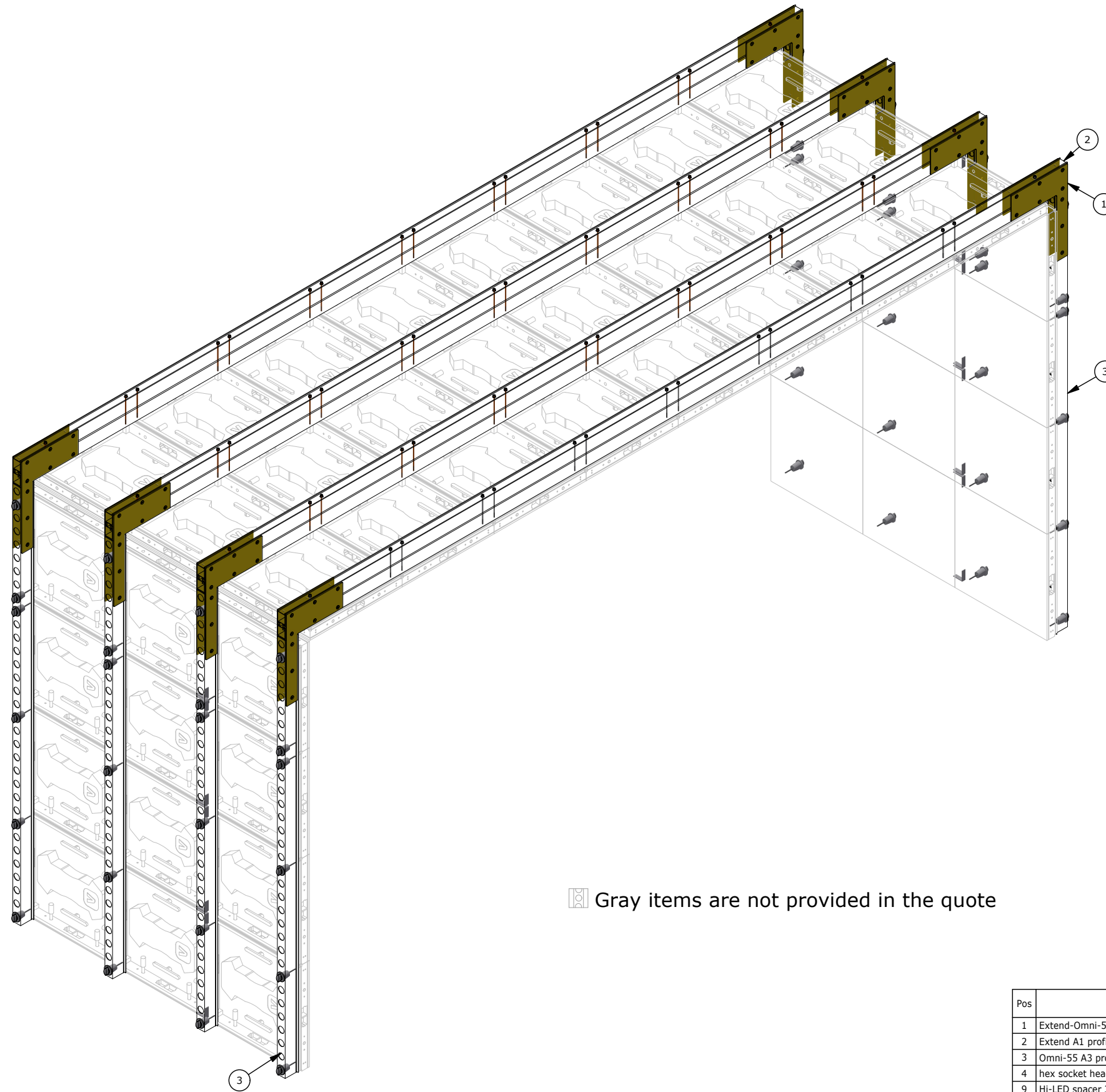

 Gray items are not provided in the quote

Pos	Description EU	Qty	Comments EU
1	Extend-Omni-55 90° reinforcement set Z	8	
2	Extend A1 profile A 4216mm	4	(90-90) Profile 1
3	Omni-55 A3 profile A 2042,5mm	8	(90-90-@31right) Profile 2
4	hex socket head screw DIN 912 - M6*140mm	64	
9	Hi-LED spacer 3,5mm X	16	Not in quote!
11	quick tightener LS M6/D30 x 80 quickfix A	48	Not in quote!

Client	The Event Co. - London Ltd	Project	SQ1-25014689	Page 3 / 4
Ref.	LED bridge structure	Author	WDT	
Date	26/05/2025	Version	2	

+32 (0)56 17 19 60 - www.aluision.com

# Structure

## Dimensions

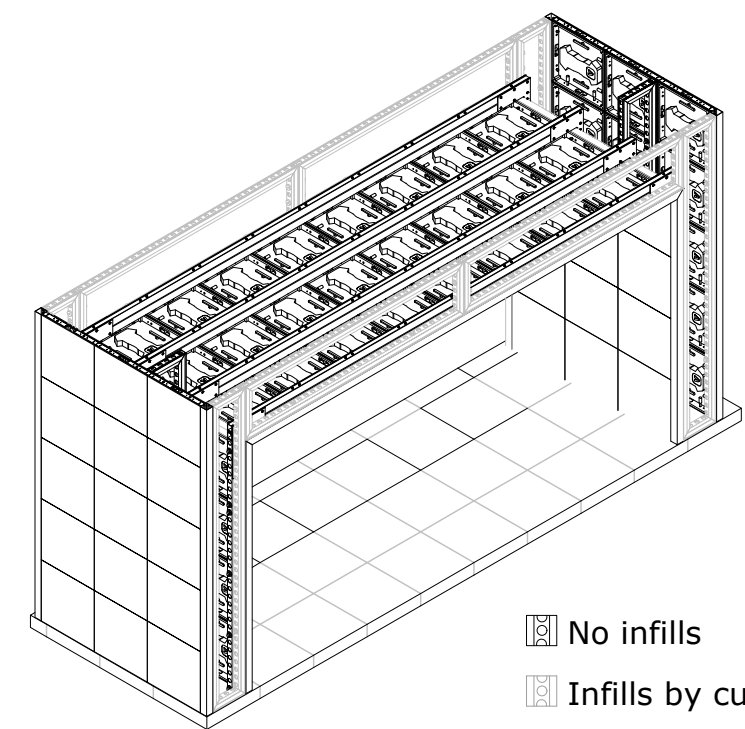
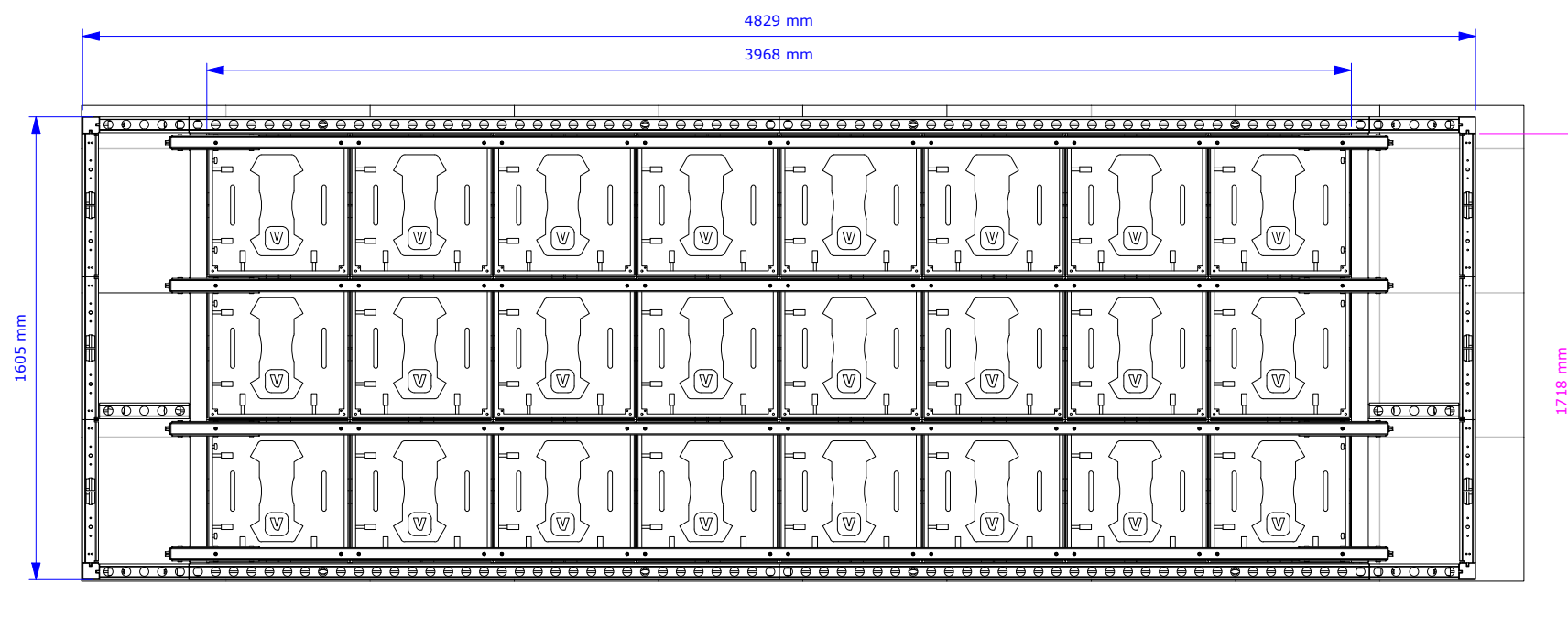
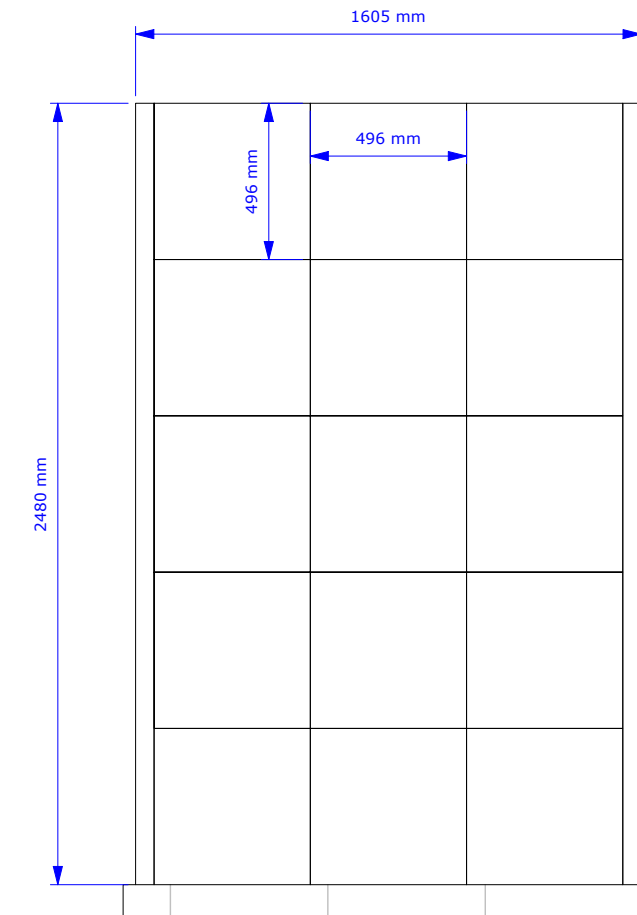
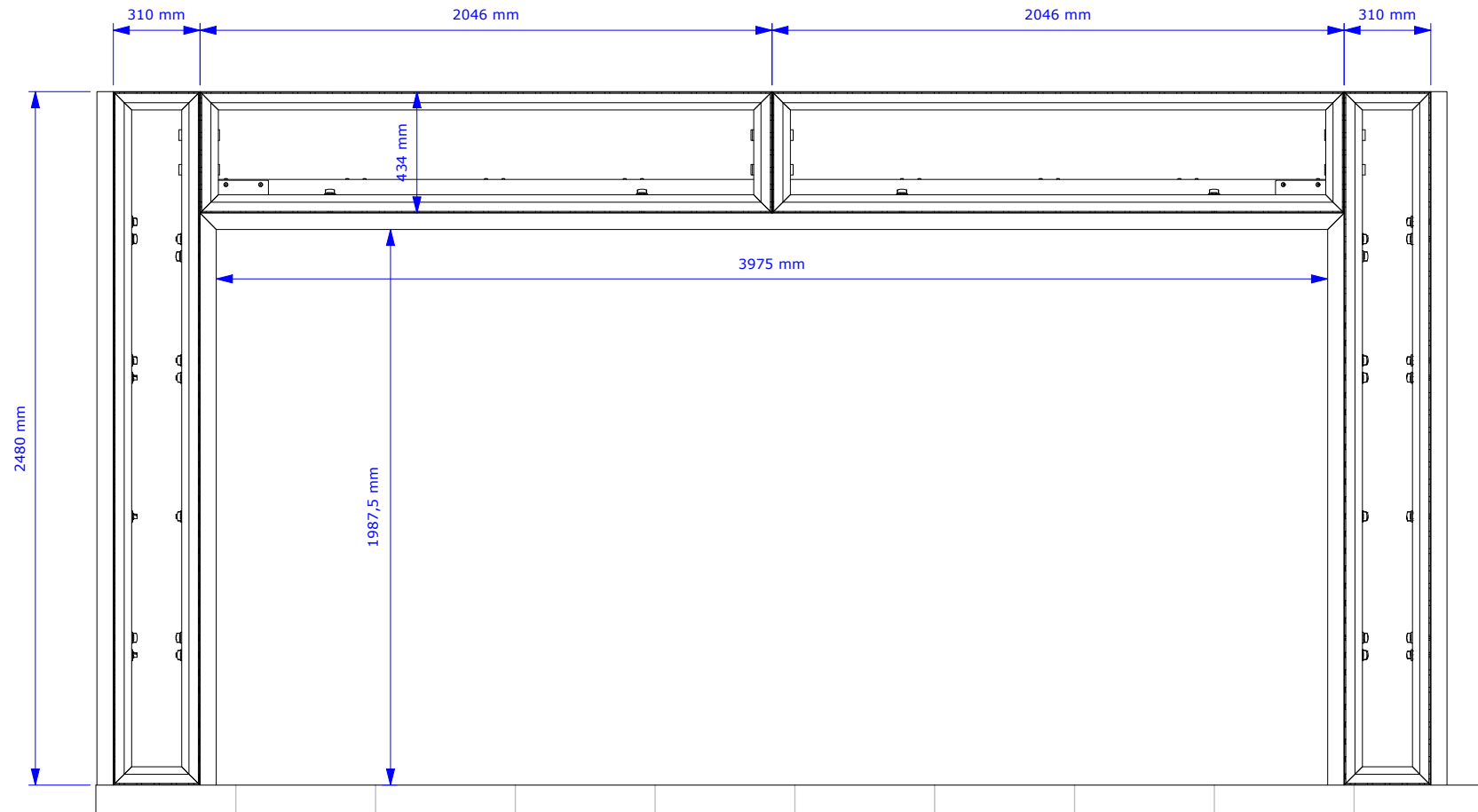

- No infills
- Infills by customer

Client	The Event Co. - London Ltd	Project	SQ1-25014689	Page 4 / 4
Ref.	LED bridge structure	Author	WDT	
Date	26/05/2025	Version	2	
+32 (0)56 17 19 60 - www.aluision.com				